

► Bolt-On Montaj Şekli

1

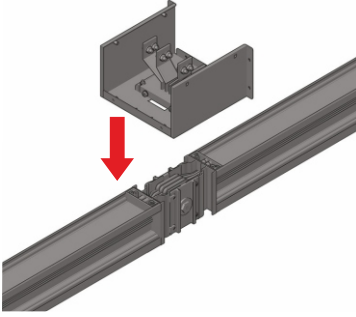

Busbar ek noktasını sıkmadan bolt-on kutusunu ek noktasına gelecek şekilde merkezine getiriniz ardından kutuyu yerleştirerek ek bloğu sıkınız.

2

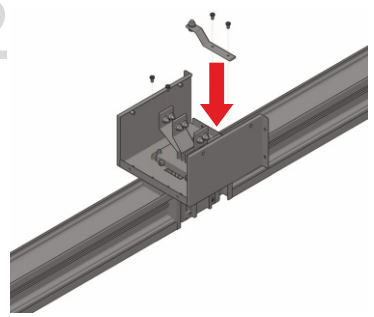

Ek yerine bolt-on kutusunu sıkıldıktan sonra topraklama iletkenini şekilde görüldüğü gibi monte ediniz.

3

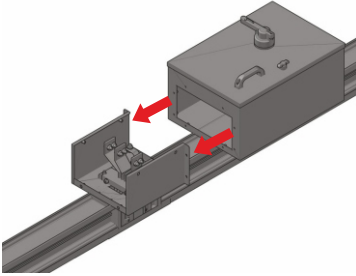

Bolt-on montajını tamamlamak için ek kutusunu busbar üzerine gelecek şekilde oturtup ek noktasına doğru kaydırınız.

4

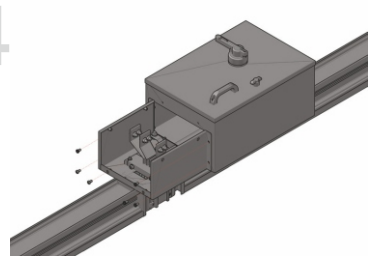

Ek kutusunu ve bolt-on arasını M6x12 vida ile sıkıştırınız.

5

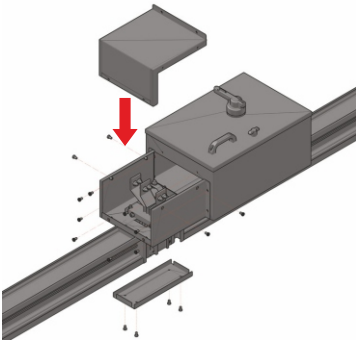

Bolt-on kapağını montaj ediniz. Ardından busbar ek kapağını bağlayınız. M6x12 vida ile sıkıştırınız.

6

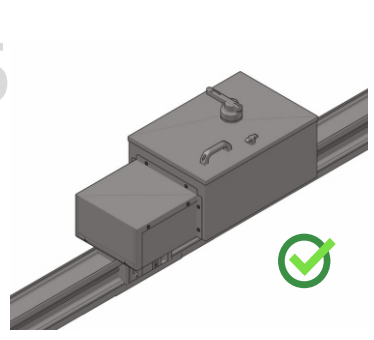

Bolt-on kapağını montajı ardından montaj işlemi sonlanır.

► Bolt-On Installation

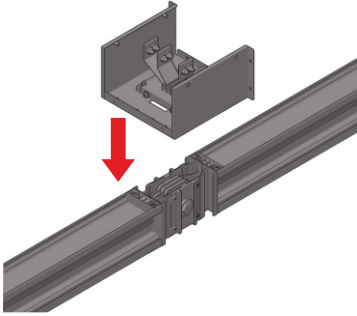

Before screwing the joint of the busbar, align the bolt-on unit with the center of the joint. Then, place the unit and screw the joint block.

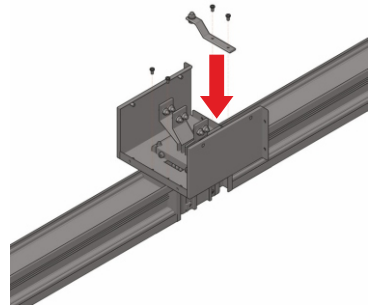

After screwing the bolt-on unit onto the joint, install the earthing conductor as shown in the figure.

3

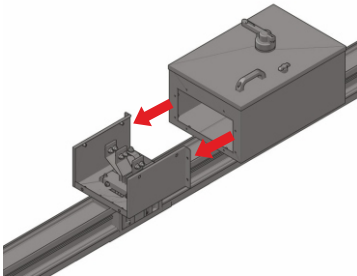

In order to complete the bolt-on installation, place the joint unit onto the busbar and slide it towards the joint.

4

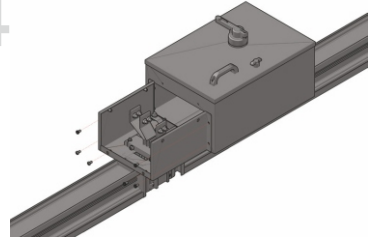

Use M6x12 screws to screw the joint unit and the bolt-on together.

5

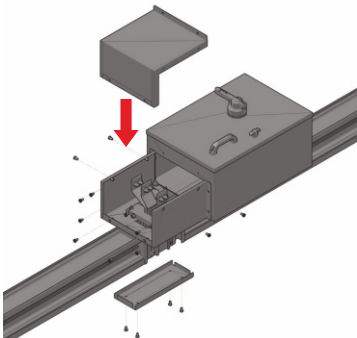

Install the bolt-on cover. Then, connect the busbar joint cover. Screw with M6x12 screws.

6

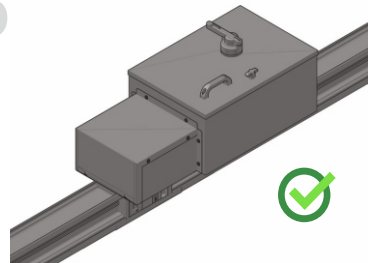

Installation is completed after installing the bolt-on cover.